

Electronic Copy

CI/SfB



Rockwool Rockpanel B.V.

Wern Tarw
Pencoed
Bridgend
Mid Glamorgan CF35 6NY
Tel: 01656 863210 Fax: 01656 863611
e-mail: info@rockpanel.co.uk
website: www.rockpanel.co.uk

(41)	Nm6
------	-----

**Agrément
Certificate
No 04/4168**
Second issue*

Designated by Government
to issue
European Technical
Approvals

ROCKPANEL ROCKCLAD DURABLE AND ROCKPANEL DURABLE ANTI-GRAFFITI PANELS

Panneaux de façade
Verkleidungsplatten

Product



• THIS CERTIFICATE RELATES TO ROCKPANEL ROCKCLAD DURABLE AND ROCKPANEL DURABLE ANTI-GRAFFITI PANELS, COMPRESSED AND BOUND ROCK WOOL BOARDS WITH A DECORATIVE COATING ON ONE SIDE, FOR USE AS A BACK VENTILATED CLADDING PANEL SYSTEM.

• The panels have been assessed for use externally on buildings as a decorative and protective facing.

• The panels are suitable for fixing to conventional timber sub-frame or aluminium rail support.

• It is essential that the panels are installed in accordance with the Certificate holder's instructions and the requirements of this Certificate.

Regulations

1 The Building Regulations 2000 (as amended) (England and Wales)



The Secretary of State has agreed with the British Board of Agrément the aspects of performance to be used by the BBA in assessing the compliance of cladding panels with requirements of the Building Regulations. In the opinion of the BBA, Rockpanel Rockclad Durable and Rockpanel Durable Anti-Graffiti Panels, if used in accordance with the provisions of this Certificate, will meet or contribute to meeting, the relevant requirements.

Requirement: **A1**

Loading

Comment:

The panels have sufficient strength and stiffness to accept wind loads and to transfer them to the supporting sub-frame. See sections 7.2, 9.4 and 9.5 of this Certificate.

Requirement: **B4(1)**

External fire spread

Comment:

The panels satisfy the Class 0 requirements. See sections 11.4 and 11.5 of this Certificate.

Requirement: **C2(b)**

Resistance to moisture

Comment:

The panels will resist the passage of rainwater to the supporting structure. See sections 10.1 and 10.3 of this Certificate.

Requirement: **Regulation 7**

Materials and workmanship

Comment:

The panels are acceptable. See section 13.1 of this Certificate.

Electronic Copy

2 The Building (Scotland) Regulations 2004



In the opinion of the BBA, Rockpanel Rockclad Durable and Rockpanel Durable Anti-Graffiti Panels, if used in accordance with the provisions of this Certificate, will satisfy or contribute to satisfying the various Regulations and related Mandatory Standards as listed below.

Regulation:	8	Fitness and durability of materials and workmanship
Regulation:	8(1)	Fitness and durability of materials and workmanship
Comment:		The panels can contribute to a construction meeting this Regulation. See section 13.1 and the <i>Installation</i> section of this Certificate.
Regulation:	9	Building standards – construction
Standard:	1.1(a)(b)	Structure
Comment:		The panels have sufficient strength and stiffness to accept wind loads and to transfer them to the supporting sub-frame, with reference to clause 1.1.1 ⁽¹⁾⁽²⁾ . See sections 7.2, 9.4 and 9.5 of this Certificate.
Standard:	2.4	Cavities
Comment:		The panels have a ‘low risk’ surface classification, with reference to the relevant clauses of 2.4.1 ⁽¹⁾⁽²⁾ to 2.4.9 ⁽²⁾ . See sections 11.4 and 11.5 of this Certificate.
Standard:	2.6	Spread to neighbouring buildings
Comment:		The panels have a ‘low risk’ surface classification. The products incorporate materials which would not be classed as ‘non-combustible’. Completed walls, therefore, would be regarded as unprotected areas, with reference to the relevant clauses of 2.6.1 ⁽¹⁾⁽²⁾ to 2.6.7 ⁽²⁾ . See sections 11.4 and 11.5 of this Certificate.
Standard:	2.7	Spread on external walls
Comment:		The panels have a ‘low risk’ surface classification. The systems incorporate materials which would not be classed as ‘non-combustible’ and therefore should not be used on walls one metre or less from a boundary, with reference to clauses of 2.7.1 ⁽¹⁾⁽²⁾ to 2.7.2 ⁽²⁾ . See sections 11.4 and 11.5 of this Certificate.
Standard:	3.10	Precipitation
Comment:		The panels will contribute to a construction satisfying this Standard, with reference to the relevant clauses of 3.10.0 ⁽¹⁾⁽²⁾ to 3.10.7 ⁽¹⁾⁽²⁾ . See sections 10.1 and 10.3 of this Certificate.
Regulation:	12	Building standards – conversions
Comment:		All comments given for the panels under Regulation 9 also apply to this Regulation, with reference to clause 0.12.1 ⁽¹⁾⁽²⁾ and Schedule 6 ⁽¹⁾⁽²⁾ . (1) Technical Handbook (Domestic). (2) Technical Handbook (Non-Domestic).

3 The Building Regulations (Northern Ireland) 2000



In the opinion of the BBA, Rockpanel Rockclad Durable and Rockpanel Durable Anti-Graffiti Panels, if used in accordance with the provisions of this Certificate, will satisfy or contribute to satisfying, the various Building Regulations as listed below.

Regulation:	B2	Fitness of materials and workmanship
Comment:		The panels are acceptable. See section 13.1 of this Certificate.
Regulation:	C4	Resistance to ground moisture and weather
Comment:		The panels will resist the passage of rainwater to the supporting structure. See sections 10.1 and 10.3 of this Certificate.
Regulation:	D1	Stability
Comment:		The panels have sufficient strength and stiffness to accept wind loads and to transfer them to the supporting sub-frame. See sections 7.2, 9.4 and 9.5 of this Certificate.
Regulation:	E5	External fire spread
Comment:		The panels satisfy the Class 0 requirements. See sections 11.4 and 11.5 of this Certificate.

4 Construction (Design and Management) Regulations 1994 (as amended) Construction (Design and Management) Regulations (Northern Ireland) 1995 (as amended)

Information in this Certificate may assist the client, planning supervisor, designer and contractors to address their obligations under these Regulations.

See section: 6 *Delivery and site handling* (6.3).

Technical Specification

5 Description

5.1 Rockpanel Rockclad Durable and Rockpanel Durable Anti-Graffiti Panels form part of a back-ventilated system, comprising bound rock wool panels fixed onto a timber sub-frame or aluminium rail support.

5.2 The panels are made from compressed rock wool with thermo-hardening synthetic binding compounds. All panels are surface treated with a multi-layered, water-based acrylic decorative finish applied to one side, and are available in a range of colours.

5.3 Rockpanel Rockclad Durable has a curtain-applied (flat) paint finish and Rockpanel Durable Anti-Graffiti has a metallic or roller-applied (textured) wood-effect paint finish, with a curtain-applied (flat) scratch-resistant transparent lacquer paint finish.

5.4 The panels can be used externally as a decorative and protective cladding. Externally, the panels are also suitable for fascias and soffits.

5.5 The panels are available in the standard sizes detailed in Table 1.

Table 1 Nominal physical properties

Property	Value
Length (mm)	
Rockpanel Rockclad Durable	3050, 2500
Rockpanel Durable Anti-Graffiti	3050
Width (mm)	1200
Thickness (mm)	
Rockpanel Rockclad Durable	6 or 8
Rockpanel Durable Anti-Graffiti	8
Density (kgm ⁻³) (nominal)	1050
Binder content %	12
Weight (kgm ⁻²)	
6 mm panel	6.3
8 mm panel	8.4
Water vapour resistance (MNsg ⁻¹)	
6 mm and 8 mm panel	
Rockpanel Rockclad Durable	9
Rockpanel Durable Anti-Graffiti	19
Thermal conductivity (Wm ⁻¹ K ⁻¹)	
6 mm and 8 mm panel	0.35
Dimensional stability [m(m°C) ⁻¹]	11 x 10 ⁻⁶
Dimensional stability per 10% change RH (m m ⁻¹)	8 x 10 ⁻⁵

5.6 The panels are attached to the building by fixing to a timber sub-frame or aluminium rail support (see Figures 1 and 2).

5.7 Ancillary items⁽¹⁾ include:

- PVC-U profile joints (35 mm wide) and sealing strips
- extruded aluminium chair profile joints (35 mm wide) and sealing strips
- EDPM self-adhesive foam, flexible gaskets (3 mm by 60 mm or 36 mm wide) for vertical end and intermediate supports
- internal and external square or curved shape corner profiles
- trims

- AISI 316 stainless steel 1.4436⁽²⁾ torx screws, colour matched to the boards
- AISI 316 stainless steel 1.4436⁽²⁾ ring-shank nails, colour matched to the boards
- aluminium rivets
- cleaning agent
- breather membrane.

(1) See Table 2.

(2) To BS EN 10088-1 : 2005.

Figure 1 Typical timber ventilated sub-frame detail

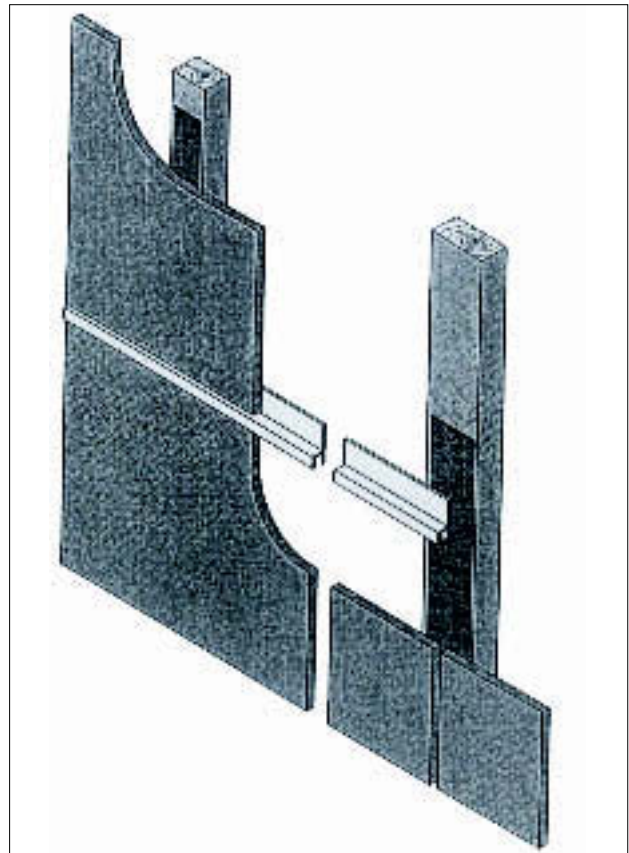
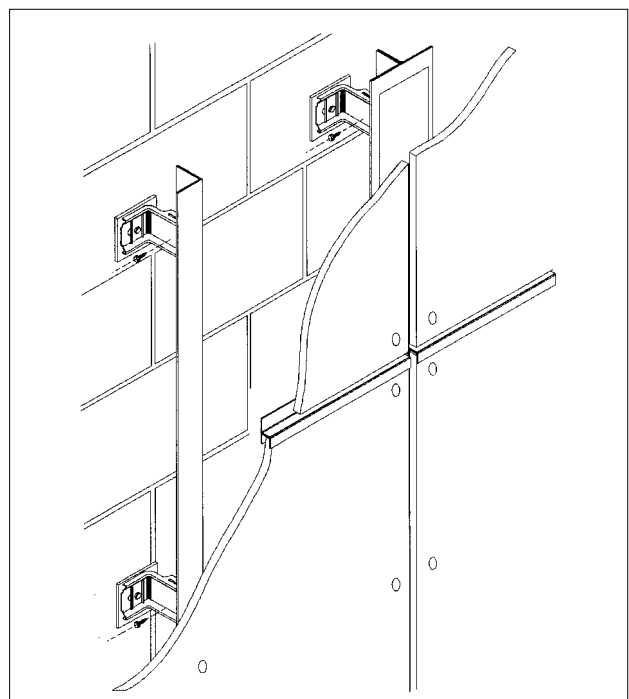

Figure 2 Typical aluminium rail support detail



5.8 The fixings specified for use with the cladding are given in Table 2.

Table 2 Fixings

	Nail (for timber sub-frame)	Screw (for timber sub-frame)	Rivet ⁽¹⁾ (for aluminium rail support)
Type	ring shank	torx head	—
Material	stainless steel	stainless steel	aluminium AlMg5
Length (mm)	32	35	18
Shank diameter (mm)	2.7–2.9	3.5–4.5	5
Head diameter (mm)	6.0	9.0–9.6	14
Hole diameter (mm)			
fixed point	3	5	5.2
moving point	3	5	9.0
Head	flat colour coated	colour coated	colour coated

(1) For correct fixing, use riveting tool with rivet spacer tool.

6 Delivery and site handling

6.1 Panels are delivered on shrink-wrapped palletted containers with edge and corner protections. Panels are interleaved with protective foam. Pallets should be stored on level ground and not be stacked more than two high.

6.2 Pallets carry a label bearing the Certificate holder's name, product type, the quantity and dimensions of the contents and a label bearing the BBA identification mark incorporating the number of this Certificate. Each panel is identified on the back with product type, composition and colour.

6.3 Panels must be handled with care to avoid edge and corner damage. Individual panels must be lifted off the stack, not pulled or pushed, and carried upright. Once the pallets have been opened, the panels must be protected against the weather, preferably under cover.

Design Data

7 General

7.1 Rockpanel Rockclad Durable and Rockpanel Durable Anti-Graffiti Panels are suitable for use externally as decorative and protective facings, designed as back-ventilated rainscreen claddings fixed to a timber sub-frame or aluminium rail support. All vertical edges are sealed with EDPM gaskets. Horizontal edges are either all open or sealed with profile joints, with a ventilation gap at the top and bottom of the clad wall area. In timber stud walls, a breather membrane can be incorporated behind the product.



7.2 The wall and sub-frame to which the cladding is fixed should be structurally sound and constructed in accordance with the requirements of the relevant building regulations and national standards. The components of the sub-frame system should be durable and corrosion resistant.

7.3 The wall to which the cladding is fixed should be watertight and preferably airtight.

7.4 Brick or blockwork walls, to which the timber sub-frame or aluminium rail support is fixed, should be constructed in the conventional manner in accordance with one of the following technical specifications:

- BS 5628-1 : 2005 and BS 5628-3 : 2005, and
- relevant national Building Regulations.

7.5 Timber stud walls and timber battens fixed to masonry walls should be constructed in accordance with BS 5268-2 : 2002 and preservative treated in accordance with BS 5268-5 : 1989 and BS 8417 : 2003. Studding and framing should be adequately supported by noggings to ensure rigidity. Where timber stud walls or battens are treated with cuprous preservatives, care must be taken to ensure that sufficient time is allowed for complete fixation of the preservative before the cladding is fixed.

7.6 Aluminium rail supports should be constructed in accordance with BS 8118-1 : 1991 and BS 8118-2 : 1991.

7.7 Panels are normally fixed with a minimum vertical gap of from 3 mm to 6 mm between them. As panels are dimensionally stable, provision does not need to be made for thermal movement. However, where substrate movement may occur, appropriate clearances should be maintained between boards and for fixings.

7.8 On timber sub-frames at all vertical joints, a waterproof gasket is placed between the panels and the supports. Purpose-made profile joints are available for horizontal and corner joints as required.

7.9 Ventilation should be in accordance with BS 8200 : 1985, eg a continuous cavity pathway of 10 mm width behind the cladding and 5 mm continuous opening (or equivalent slots) at the top and bottom. Further ventilation must be provided in vertical runs exceeding 20 m (see section 10.1). For those panel systems requiring NHBC approval, a continuous pathway of 35 mm width behind the cladding and 10 mm continuous opening at the top and bottom is required.

7.10 Where buildings need to comply with NHBC Standards or *Zurich Building Guarantee Technical Manual*, specifiers should observe the requirements of these Standards.

7.11 For non-ventilated constructions, the following limited applications apply (see sections 7.10, 10.3 and 14.2):

- infilling panel in a window frame without a horizontal gap between the panels
- use of panel length without horizontal gaps
- only for panels fixed to wooden battens
- vertical joints with a 3 mm by 60 mm EPDM self-adhesive foam gasket.

8 Practicability of installation

The panels are easy to install under normal site conditions using equipment and techniques commonly used for claddings.

9 Strength and stability

9.1 The general arrangement of timber supports is shown in Figure 1 and aluminium supports in Figure 2. The fixing locations for the panels are shown in Table 3 and Figure 3.

Table 3 Fixing locations

Panel thickness (mm)	Minimum a_{R1}/a_{R2} (mm)	Maximum span (a) between timber/aluminium supports (mm)	Maximum fixing centres (mm) (b)	panel position	nail	screw	rivet
6	15/50	400	400	panel perimeter	300	300	300
6	15/50	400	400	intermediate supports	300	300	300
8	15/50	600	600	panel perimeter	400	600	600
8	15/50	600	600	intermediate supports	400	600	600

Figure 3 Fixing locations

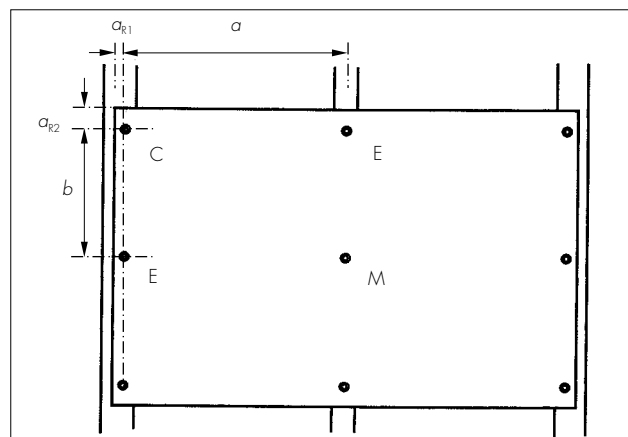

9.2 For timber sub-frames the panels may be fixed using either stainless steel screws or stainless steel ring-shank nails. Screws must be 25 mm longer than the panel thickness and nails 22 mm longer. For aluminium rail supports the panels are fixed using aluminium rivets.

9.3 Fixings must not be closer than 15 mm to a vertical edge (a_{R1}) and 50 mm to a horizontal edge (a_{R2}) (see Figure 3).

9.4 Provided that fixings are as given in Table 2 and the fixing locations are as shown in Table 3, the design loads (including a safety factor of 3) which may be taken by the fixings, are given in Table 4.

9.5 The suitability of the cladding for a particular application should always be checked by a suitably-qualified engineer who will need to take into account such factors as the nature, level of uncertainty and anticipated variability of applied wind loads (calculated in accordance with BS EN 1991-1-4 : 2005 and BS 6399-2 : 1997) the predicted long-term performance of the panels (see section 1.3) and the level of risk of failure.

Table 4 Design loads — permissible pull-over strength in N/position of the fixing

Fixing	Panel thickness (mm)	Fixing position	Design load (N)
Nail	6	middle	155
		edge	100
		corner	85
	8	middle	190
		edge	190
		corner	130
Screw	6	middle	230
		edge	125
		corner	75
	8	middle	330
		edge	180
		corner	85
Rivet	6	middle	255
		edge	150
		corner	100
	8	middle	435
		edge	230
		corner	115

9.6 Where increased strength and stability are required, consideration should be given to reducing the spacing of the fixings and supports.

9.7 The fixing of a timber or aluminium sub-frame to the substructure should be designed in accordance with the relevant Standard and is not covered by this Certificate.

9.8 For all panels, the characteristic bending strength and modulus of elasticity in both directions of bending may be taken as 27 Nmm⁻² and 3380 Nmm⁻² respectively.

Impact

9.9 It is recommended that use of the product is restricted to locations where there is high incentive to exercise care and low risk of hard body or large soft body impacts. The 8 mm panel should be restricted to use in locations covered by categories D, E and F and the 6 mm panel, categories D and F, of BS 8200 : 1985.

9.10 The panels should not be taken into account when designing a timber stud wall to resist racking forces.

10 Weathertightness

10.1 The panels are suitable for use as a back-ventilated rainscreen provided that:

- adequate ventilation is allowed in accordance with BS 8200 : 1985, including a minimum 10 mm width continuous cavity pathway behind the cladding and minimum 5 mm continuous horizontal opening (or equivalent slots) at the top and bottom of each vertical run (see also section 7.9)
- cladding areas should not exceed 20 m in height without the addition of further ventilation entry and exit points. This is subject to cavity barrier and fire stop requirements
- where internal relative humidity conditions in the building exceed 65% (maximum normal

domestic condition) and where the wall does not incorporate a vapour check, additional 5 mm ventilation slots should be incorporated to give a maximum vertical distance of eight metres between slots.

10.2 Provision must be made for water penetrating the cladding to drain away from the base.



10.3 The panels are also suitable for use in non-ventilated constructions, in locations of moderate or limited exposure (see section 14.2).

11 Properties in relation to fire

11.1 When tested to EN ISO 11925-2 : 2002 and EN 13823 : 2002, the panels can satisfy the Euroclass classifications in accordance with EN 13501-1 : 2002 (see Table 5).

Table 5 Euro classification to EN 13501-1 : 2002

Subconstruction	Rockpanel Rockclad Durable	Rockpanel Durable Anti-Graffiti
Wood	B-s2, d0 ⁽¹⁾	B-s2, d0 ⁽²⁾
Aluminium	B-s1, d0 ⁽³⁾	B-s2, d0 ⁽⁴⁾

- (1) Green paint finish. (2) Brown paint finish. (3) Green and white paint finishes. (4) Light brown paint finish.

11.2 The performances stated in section 11.1 may not be achieved by other colours in the range. The performance of other colours should be confirmed by:

England and Wales

Test or assessment, in accordance with Approved document B, Appendix A, Clause 1

Scotland

Test to conform with Regulation 9, Table to Annex 2C⁽¹⁾ and 2E⁽²⁾

- (1) Technical Handbook (Domestic). (2) Technical Handbook (Non-Domestic).

Northern Ireland

Test or assessment by a UKAS accredited laboratory or an independent consultant with appropriate experience.

11.3 Euro-classification is only valid if installation and horizontal and vertical joints are in accordance with the executed tests.



11.4 The external surfaces of the system are classified as Class 0 or 'low risk' as defined in the documents supporting the national Building Regulations. Reference should be made to:

England and Wales

Approved Document B, Paragraphs 13.5 to 13.7

Scotland

Mandatory Standards 2.6 and 2.7, with reference to the relevant clauses of 2.6.1⁽¹⁾⁽²⁾ to 2.6.7⁽²⁾ and 2.7.1⁽¹⁾⁽²⁾ and 2.7.2⁽²⁾ respectively and Annex 2c⁽¹⁾ and Annex 2e⁽²⁾

- (1) Technical Handbook (Domestic). (2) Technical Handbook (Non-Domestic).

Northern Ireland

Technical Booklet E, Paragraph 4.3.

11.5 Any cavities within the system (such as those formed between the cladding and substrate) must have appropriate fire stopping, without blocking ventilation pathways, in accordance with:

England and Wales

Approved Document B, Section 10

Scotland

Mandatory Standards 2.4, 2.6 and 2.7, with reference to the relevant clauses of 2.4.1⁽¹⁾⁽²⁾ to 2.4.9⁽²⁾, 2.6.1⁽¹⁾⁽²⁾ to 2.6.7⁽²⁾ and 2.7.1⁽¹⁾⁽²⁾ and 2.7.2⁽²⁾ respectively

- (1) Technical Handbook (Domestic). (2) Technical Handbook (Non-Domestic).

Northern Ireland

Technical Booklet E, Sections 3.35 to 3.39 and Section 4.

12 Maintenance

12.1 The panels are generally self-cleaning under normal climatic conditions but where soiling occurs they may be cleaned with cold water or water with mild detergent. Strong alkaline or abrasive cleaners or high-pressure flushing should not be used.

12.2 Paint or marker pen marks on the anti-graffiti panels can be removed with the ancillary cleaning agent. Suitable hand protection may be required.

12.3 Panels that are located where impact damage may occur should be fixed in such a way as to permit easy replacement.

12.4 Checks should be carried out periodically to ensure that ventilation and drainage pathways remain clear.

13 Durability



13.1 The panels are expected to perform effectively as a cladding system with an ultimate life of approximately 40 years.

13.2 The Rockpanel Rockclad Durable Panels will have a decorative life of approximately 15 years and the Rockpanel Durable Anti-Graffiti Panels will have a decorative life of approximately 25 years.

Installation

14 General

14.1 Installation of Rockpanel Rockclad Durable and Rockpanel Durable Anti-Graffiti Panels must be carried out in accordance with the manufacturer's instructions. The panels are easily cut and drilled using ordinary woodworking tools.

14.2 The suitability of unventilated constructions on façades exposed to rain, should be agreed in advance with the Certificate holder. Additional weatherproofing in the form of a suitable breather membrane should be incorporated behind the panels.

Electronic Copy

14.3 Allowances must be made for the expansion/contraction of the aluminium rail support system.

14.4 The use of the panels with insulation has not been assessed and is outside the scope of this Certificate.

15 Procedure

15.1 The wall is surveyed to determine the extent of any packing that may be needed to ensure that the framing forms a suitably-flat/level plane on which to fit the panels.

15.2 The sub-frame or carrier rail supports (see Figures 1 and 2) are fixed to the supporting construction. Aluminium carrier rail systems include Omega, Zed and Rocktrack (for uneven surfaces). Omega and Zed rails are of a fixed depth and Rocktrack has adjustable depth. The frame can be made in situ or prefabricated.

15.3 Joint gaskets are fixed to the edge vertical supports and intermediate gaskets to the intermediate supports. Intermediate vertical supports are packed to suit the thickness of the joint or strip.

15.4 Panels and chair profiles are fixed centred on the frame giving a minimum 3 mm to 6 mm wide open vertical joint between panels.

15.5 When using screw fixings, holes are drilled into the panels not less than 15 mm from a vertical edge and 50 mm from a horizontal edge (see Figure 3). The panels are fixed making sure that the screws are not over-tightened. Rivets are used with the aluminium rail support. For correct fixing, use riveting tool with riveter spacer tool.

15.6 When using nails, a similar procedure is observed. Pre-drilling the panels is not necessary.

15.7 The panels are installed from bottom to top leaving the last line of screws loose until the horizontal profile joint or sealing strip is fixed.

Technical Investigations

The following is a summary of the technical investigations carried out on Rockpanel Rockclad Durable and Rockpanel Durable Anti-Graffiti Panels.

16 Tests

The following tests were carried out by independent test houses:

- hard body impact resistance
- soft body impact resistance
- design strength of fixings
- bending strength
- modulus of elasticity
- pull-out strength of fixings
- pull-through strength of the panels
- resistance to frost
- freeze/thaw resistance
- UV resistance and colourfastness

- water absorption %
- resistance to water vapour transmission
- dimensional stability with temperature and humidity
- durability
- properties in relation to fire.

17 Investigations

17.1 The manufacturer's installation instructions were evaluated and the procedure outlined found to be practicable.

17.2 The manufacturing process was examined, including the methods adopted for quality control and details were obtained on the quality and composition of the materials used.

17.3 An assessment of the system was made to evaluate its effectiveness as a back-ventilated rainscreen with open or filled joints.

Bibliography

BS 5268-2 : 2002 *Structural use of timber — Code of practice for permissible stress design, materials and workmanship*

BS 5268-5 : 1989 *Structural use of timber — Code of practice for the preservative treatment of structural timber*

BS 5628-1 : 2005 *Code of practice for the use of masonry — Structural use of unreinforced masonry*
BS 5628-3 : 2005 *Code of practice for the use of masonry — Materials and components, design and workmanship*

BS 6399-2 : 1997 *Loading for buildings — Code of practice for wind loads*

BS 8118-1 : 1991 *Structural use of aluminium — Code of practice for design*

BS 8118-2 : 1991 *Structural use of aluminium — Specification for materials, workmanship and protection*

BS 8200 : 1985 *Code of practice for design of non-loadbearing external vertical enclosures of buildings*

BS 8417 : 2003 *Preservation of timber — Recommendations*

BS EN 10088-1 : 2005 *Stainless steels — List of stainless steels*

BS EN 1991-1-4 : 2005 *Eurocode 1 : Actions on structures — General actions — Wind actions*

EN 13501-1 : 2002 *Fire classification of construction products and building elements — Classification using test data from reaction to fire tests*

EN 13823 : 2002 *Reaction to fire tests for building products — Building products excluding floorings exposed to the thermal attack by a single burning item*

Conditions of Certification

18 Conditions

18.1 This Certificate:

- relates only to the product/system that is named and described on the front page
- is granted only to the company, firm or person named on the front page — no other company, firm or person may hold or claim any entitlement to this Certificate
- is valid only within the UK
- has to be read, considered and used as a whole document — it may be misleading and will be incomplete to be selective
- is copyright of the BBA
- is subject to English law.

18.2 References in this Certificate to any Act of Parliament, Regulation made thereunder, Directive or Regulation of the European Union, Statutory Instrument, Code of Practice, British Standard, manufacturers' instructions or similar publication, are references to such publication in the form in which it was current at the date of this Certificate.

18.3 This Certificate will remain valid for an unlimited period provided that the product/system and the manufacture and/or fabrication including all related and relevant processes thereof:

- are maintained at or above the levels which have been assessed and found to be satisfactory by the BBA
- continue to be checked as and when deemed appropriate by the BBA under arrangements that it will determine
- are reviewed by the BBA as and when it considers appropriate.

18.4 In granting this Certificate, the BBA is not responsible for:

- the presence or absence of any patent, intellectual property or similar rights subsisting in the product/system or any other product/system
- the right of the Certificate holder to manufacture, supply, install, maintain or market the product/system
- individual installations of the product or system, including the nature, design, methods and workmanship of or related to the installation
- the actual works in which the product/system is installed, used and maintained, including the nature, design, methods and workmanship of such works.

18.5 Any information relating to the manufacture, supply, installation, use and maintenance of this product/system which is contained or referred to in this Certificate is the minimum required to be met when the product/system is manufactured, supplied, installed, used and maintained. It does not purport in any way to restate the requirements of the Health & Safety at Work etc Act 1974, or of any other statutory, common law or other duty which may exist at the date of this Certificate or in the future; nor is conformity with such information to be taken as satisfying the requirements of the 1974 Act or of any present or future statutory, common law or other duty of care. In granting this Certificate, the BBA does not accept responsibility to any person or body for any loss or damage, including personal injury, arising as a direct or indirect result of the manufacture, supply, installation, use and maintenance of this product/system.



In the opinion of the British Board of Agrément, Rockpanel Rockclad Durable and Rockpanel Durable Anti-Graffiti Panels are fit for their intended use provided they are installed, used and maintained as set out in this Certificate. Certificate No 04/4168 is accordingly awarded to Rockwool Rockpanel B.V.

On behalf of the British Board of Agrément

Date of Second issue: 5th October 2006

A handwritten signature in black ink, appearing to read 'G. A. Cooper'.

Chief Executive

**Original Certificate issued 10th November 2004. This amended version includes change of product name, revised text in the Properties in relation to fire section, reference to revised national Building Regulations and British Standards and new Conditions of Certification.*